

Short Environmental Assessment Form

Part 1 - Project Information

Instructions for Completing

Part 1 – Project Information. The applicant or project sponsor is responsible for the completion of Part 1. Responses become part of the application for approval or funding, are subject to public review, and may be subject to further verification. Complete Part 1 based on information currently available. If additional research or investigation would be needed to fully respond to any item, please answer as thoroughly as possible based on current information.

Complete all items in Part 1. You may also provide any additional information which you believe will be needed by or useful to the lead agency; attach additional pages as necessary to supplement any item.

Part 1 – Project and Sponsor Information			
Name of Action or Project: <i>McClure Deck Addition</i>			
Project Location (describe, and attach a location map): <i>Side yard - 37 Brittany Dr. West Hurley, NY 12491</i>			
Brief Description of Proposed Action: <i>125 sq addition to Wood deck @ above ground pool</i>			
Name of Applicant or Sponsor: <i>Clint McClure</i>		Telephone: <i>914-474-9576</i>	
		E-Mail: <i>clint@mcc-i.net</i>	
Address: <i>37 Brittany Dr.</i>			
City/PO: <i>West Hurley</i>		State: <i>NY</i>	Zip Code: <i>12491</i>
1. <u>Does the proposed action only involve the legislative adoption of a plan, local law, ordinance, administrative rule, or regulation?</u>		NO	YES
If Yes, attach a narrative description of the intent of the proposed action and the environmental resources that may be affected in the municipality and proceed to Part 2. If no, continue to question 2.		<input checked="" type="checkbox"/>	<input type="checkbox"/>
2. <u>Does the proposed action require a permit, approval or funding from any other government Agency?</u>		NO	YES
If Yes, list agency(s) name and permit or approval: <i>Town of Hurley; Building Permit</i>		<input type="checkbox"/>	<input checked="" type="checkbox"/>
3. a. <u>Total acreage of the site of the proposed action?</u>		<i>0.28</i> acres	
b. <u>Total acreage to be physically disturbed?</u>		<i>0.0034</i> acres	
c. <u>Total acreage (project site and any contiguous properties) owned or controlled by the applicant or project sponsor?</u>		<i>0.28</i> acres	
4. <u>Check all land uses that occur on, are adjoining or near the proposed action:</u>			
<input type="checkbox"/> Urban <input type="checkbox"/> Rural (non-agriculture) <input type="checkbox"/> Industrial <input type="checkbox"/> Commercial <input checked="" type="checkbox"/> Residential (suburban)			
<input checked="" type="checkbox"/> Forest <input type="checkbox"/> Agriculture <input type="checkbox"/> Aquatic <input type="checkbox"/> Other(Specify):			
<input type="checkbox"/> Parkland			

5. Is the proposed action,	NO	YES	N/A
a. <u>A permitted use under the zoning regulations?</u>	<input type="checkbox"/>	<input checked="" type="checkbox"/>	<input type="checkbox"/>
b. <u>Consistent with the adopted comprehensive plan?</u>	<input type="checkbox"/>	<input checked="" type="checkbox"/>	<input type="checkbox"/>
6. <u>Is the proposed action consistent with the predominant character of the existing built or natural landscape?</u>	NO <input type="checkbox"/>	YES <input checked="" type="checkbox"/>	
7. <u>Is the site of the proposed action located in, or does it adjoin, a state listed Critical Environmental Area?</u> If Yes, identify: _____	NO <input checked="" type="checkbox"/>	YES <input type="checkbox"/>	
8. a. <u>Will the proposed action result in a substantial increase in traffic above present levels?</u> b. Are public transportation services available at or near the site of the proposed action? c. Are any pedestrian accommodations or bicycle routes available on or near the site of the proposed action?	NO <input checked="" type="checkbox"/> <input type="checkbox"/> <input type="checkbox"/>	YES <input type="checkbox"/> <input type="checkbox"/> <input type="checkbox"/>	
9. <u>Does the proposed action meet or exceed the state energy code requirements?</u> If the proposed action will exceed requirements, describe design features and technologies: <u>Not applicable</u>	NO <input type="checkbox"/>	YES <input type="checkbox"/>	
10. <u>Will the proposed action connect to an existing public/private water supply?</u> If No, describe method for providing potable water: _____	NO <input checked="" type="checkbox"/>	YES <input type="checkbox"/>	
11. <u>Will the proposed action connect to existing wastewater utilities?</u> If No, describe method for providing wastewater treatment: _____	NO <input checked="" type="checkbox"/>	YES <input type="checkbox"/>	
12. a. Does the project site contain, or is it substantially contiguous to, a building, archaeological site, or district which is listed on the National or State Register of Historic Places, or that has been determined by the Commissioner of the NYS Office of Parks, Recreation and Historic Preservation to be eligible for listing on the State Register of Historic Places? b. Is the project site, or any portion of it, located in or adjacent to an area designated as sensitive for archaeological sites on the NY State Historic Preservation Office (SHPO) archaeological site inventory?	NO <input checked="" type="checkbox"/> <input checked="" type="checkbox"/>	YES <input type="checkbox"/> <input type="checkbox"/>	
13. a. <u>Does any portion of the site of the proposed action, or lands adjoining the proposed action, contain wetlands or other waterbodies regulated by a federal, state or local agency?</u> b. Would the proposed action physically alter, or encroach into, any existing wetland or waterbody? If Yes, identify the wetland or waterbody and extent of alterations in square feet or acres: _____	NO <input checked="" type="checkbox"/> <input checked="" type="checkbox"/>	YES <input type="checkbox"/> <input type="checkbox"/>	

14. Identify the typical habitat types that occur on, or are likely to be found on the project site. Check all that apply: <input type="checkbox"/> Shoreline <input type="checkbox"/> Forest <input type="checkbox"/> Agricultural/grasslands <input type="checkbox"/> Early mid-successional <input type="checkbox"/> Wetland <input type="checkbox"/> Urban <input checked="" type="checkbox"/> Suburban		
15. Does the site of the proposed action contain any species of animal, or associated habitats, listed by the State or Federal government as threatened or endangered?	NO	YES
16. Is the project site located in the 100-year flood plan?	NO	YES
17. Will the proposed action create storm water discharge, either from point or non-point sources? If Yes, a. Will storm water discharges flow to adjacent properties? b. Will storm water discharges be directed to established conveyance systems (runoff and storm drains)? If Yes, briefly describe:	NO	YES
18. Does the proposed action include construction or other activities that would result in the impoundment of water or other liquids (e.g., retention pond, waste lagoon, dam)? If Yes, explain the purpose and size of the impoundment:	NO	YES
19. Has the site of the proposed action or an adjoining property been the location of an active or closed solid waste management facility? If Yes, describe:	NO	YES
20. Has the site of the proposed action or an adjoining property been the subject of remediation (ongoing or completed) for hazardous waste? If Yes, describe:	NO	YES
<p>I CERTIFY THAT THE INFORMATION PROVIDED ABOVE IS TRUE AND ACCURATE TO THE BEST OF MY KNOWLEDGE</p> <p>Applicant/sponsor/name: <u>Clint McClure</u> Date: <u>2/27/2024</u></p> <p>Signature: <u><i>Clint McClure</i></u> Title: <u>Property Owner</u></p>		

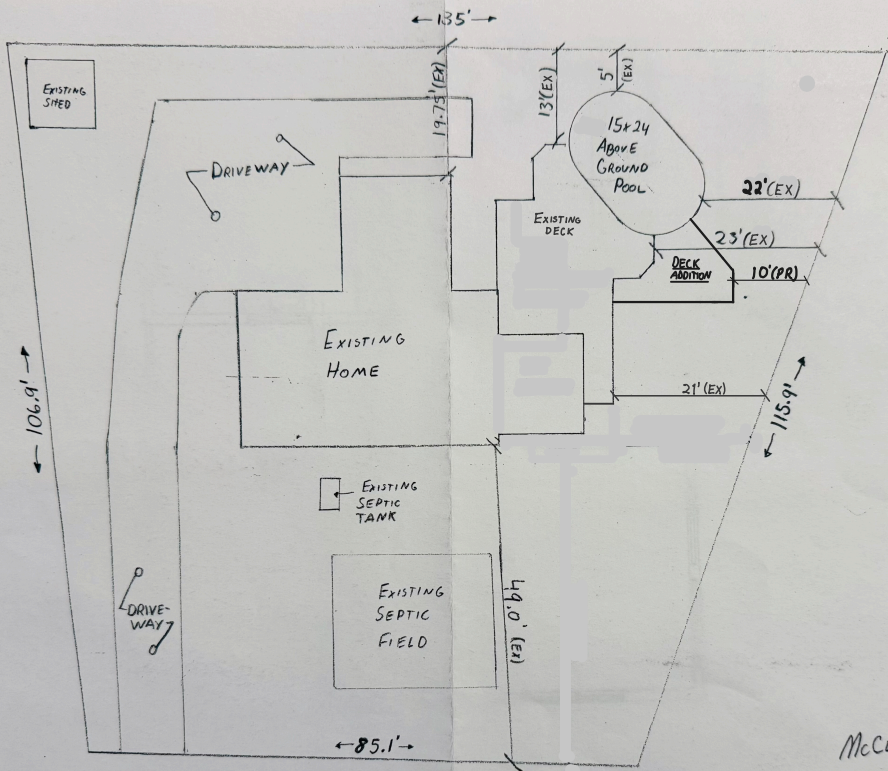

(PR) - PROPOSED
 (EX) - EXISTING

McCLURE RESIDENCE
 37 BRITTANY DRIVE
PLOT PLAN

DATE: 1/22/2024